

Interchangeable Parts - Big Game Reel Cradles

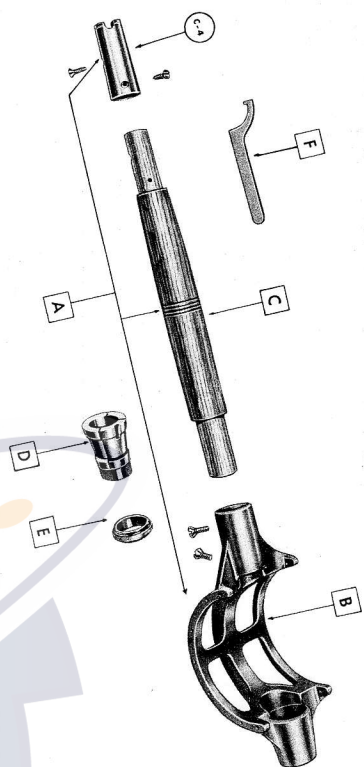

PART No.	PART NAME	REEL 806	REEL 809	REEL 810	REEL 812	REEL 814	REEL 816	PRICE
A								
C-1	Cradle, Comp. with Butt and Cap	X						18.75
C-1A	Cradle, Comp. with Butt and Cap		X					20.00
C-1B	Cradle, Comp. with Butt and Cap			X				25.00
C-1C	Cradle, Comp. with Butt and Cap				X			27.50
C-1D	Cradle, Comp. with Butt and Cap					X		36.00
C-1E	Cradle, Comp. with Butt and Cap						X	40.00
C-2	Cradle Only (with Screws)	X						8.75
C-2A	Cradle Only (with Screws)		X					10.00
C-2B	Cradle Only (with Screws)			X				12.50
C-2C	Cradle Only (with Screws)				X			14.75
C-2D	Cradle Only (with Screws)					X		18.50
C-2E	Cradle Only (with Screws)						X	22.25
B								
C-3	Butt, Comp. with Butt Cap	X						7.50
C-3A	Butt, Comp. with Butt Cap		X		X		X	10.00
C-3B	Butt, Comp. with Butt Cap			X	X		X	15.00
C-4	Butt Cap Only (with Screws)	X						5.00
C-4A	Butt Cap Only (with Screws)		X		X		X	5.00
C-4B	Butt Cap Only (with Screws)			X	X		X	5.00
C-5	Tip Chuck	X						3.00
C-5A	Tip Chuck		X		X		X	5.00
C-5B	Tip Chuck			X	X		X	8.50
C-6	Tip Chuck Nut	X						.50
C-6A	Tip Chuck Nut		X		X		X	.75
C-6B	Tip Chuck Nut			X	X		X	.90
C-7	Tip Chuck Nut Wrench	X						.80
C-7A	Tip Chuck Nut Wrench		X		X		X	1.20

BIG GAME TIPS FOR BIG GAME CRADLE REELS

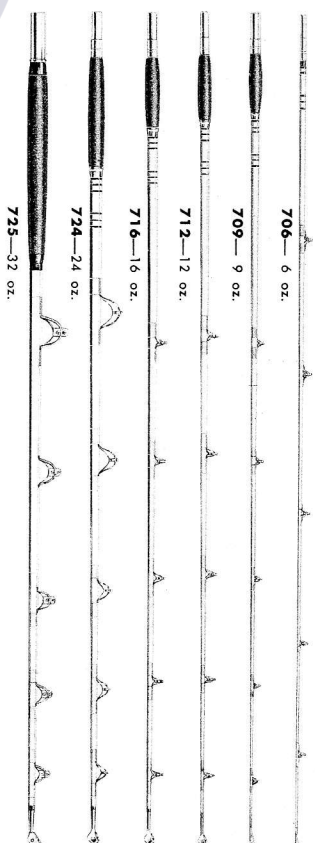

MONTAGUE 6-STRIP CONSTRUCTION
The elbow shows how Montague's genuine Tokin cane is cut into strips, then perfectly fitted and joined to give a Montague tip its matchless resiliency and strength. Also illustrated are the beautiful and sturdy silk windings, and the roller tip top that takes strain and wear off your line.

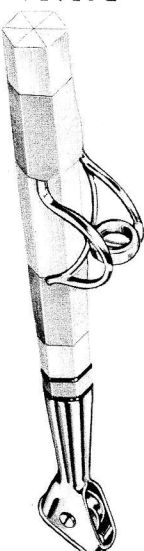

Superbly built by Montague, these selected flame finish split bamboo tips are ideal to complete the Ocean City Big Game outfit. They are partially interchangeable to help reduce the amount of "gear" a fisherman must carry.

These rugged, sporting rod tips are handsomely mounted and finished in "Big Game" fashion, with five chromium guides—and specially designed roller-type tip top on all sizes from 12 oz. up. All are closely wound with silk and have been given four coats of varnish. Forward grips are of cork and rubber sure-grip composition. (The 725 tip has newly designed, chrome plated, stainless steel roller guides as well as roller top.)

706—6 oz.—Fits 4/0 and 6/0	\$25.00
709—9 oz.—Fits 4/0 and 6/0	35.00
712—12 oz.—Fits 4/0, 6/0, 9/0, 10/0, and 12/0	35.00
716—16 oz.—Fits 9/0, 10/0 and 12/0	35.00
724—24 oz.—Fits 9/0, 10/0 and 12/0	50.00
725—32 oz.—Fits 14/0 and 16/0	75.00

FOR THE FINEST IN RODS - USE MONTAGUE